

## Introduction

Controller adopt the widely used 2.4GHz wireless technology with the features of low power consumption, long signal transmitting and strong anti-interference, etc. Controller has auto-transmitting function. Widely used on the controlling of hotel lighting and home lighting.

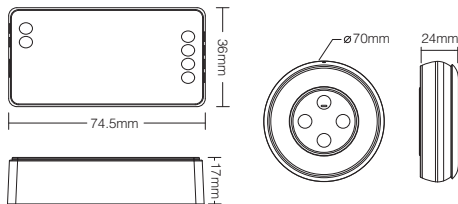

## Button Diagram

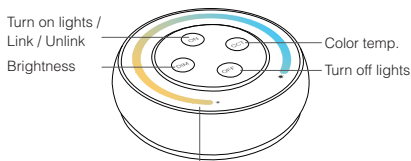

Touch ring:  
brightness, color temperature, use together.  
(It turns to adjust brightness by default if remote is not operated for 3 seconds)

## Dual White LED Controller Kits

Model No.: FUT035SA

### LED Controller

Working Voltage: DC12V~24V  
Output: 12A/Channel  
Total Output: Max 12A  
RF: 2.4GHz  
Control Distance: 30m  
Working Temperature: -10~40°C  
Output Connection: Common anode

### Sunrise Remote

Working Voltage: 3V(AAA\*2PCS)  
Transmitting Power: 6dBm  
Standby Power: 20uA  
RF: 2.4GHz  
Modulation Method: GFSK

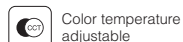

Color temperature adjustable



Remote control  
Control distance 30m



Dim brightness



Smartphone APP control  
(2.4GHz gateway is needed)



2.4G RF wireless transmission technology



Support third party voice control  
(2.4GHz gateway is needed)

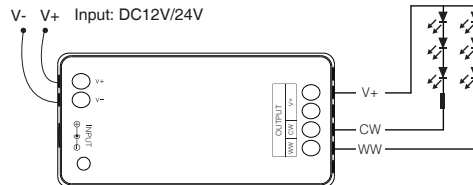

## Single Color LED Controller Kits

Model No.: FUT036SA

### LED Controller

Working Voltage: DC12V~24V  
Output: Max 12A  
RF: 2.4GHz  
Control Distance: 30m  
Working Temperature: -10~40°C  
Output Connection: Common anode

### Sunrise Remote

Working Voltage: 3V(AAA\*2PCS)  
Transmitting Power: 6dBm  
Standby Power: 20uA  
RF: 2.4GHz  
Modulation Method: GFSK



Dim brightness



Smartphone APP control  
(2.4GHz gateway is needed)



2.4G RF wireless transmission technology



Support third party voice control  
(2.4GHz gateway is needed)



Remote control  
Control distance 30m



## Install The Battery For Remote

**Note:** 2\*AAA Battery need to buy seperately

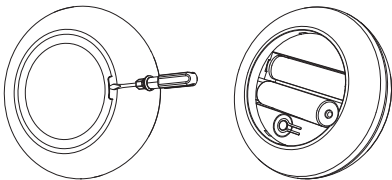

1. Open battery cover behind remote.

2. Install battery correctly and close battery cover.

## Remote Instruction

- Adjust color temperature  
Short press (CT) key once, then touch (C) to adjust color temp.
- Adjust brightness  
Short press (DIM) key once, then touch (C) to adjust brightness.

## Linking Code / Unlinking Code Instructions

**Attention:** No need to match code since its already matched code in factory setting

### Linking Code Instructions

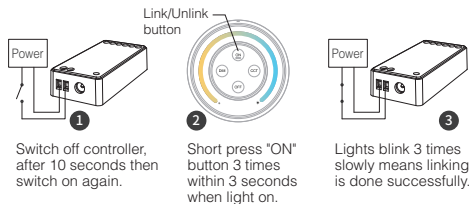

 Linking failed if light is not blinking slowly, Please follow above steps again. (Note: controller that have linked can't link again)

### Unlinking Code Instructions

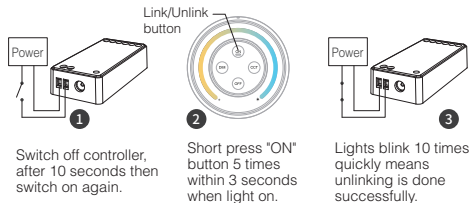

 Unlinking failed if light is not blinking quickly, Please follow above steps again. (Note: controller haven't linked that don't need to unlink)

## Signal transmitting

One controller can transmit the signals from the remote control to another controller within 30m, as long as there is a controller within 30m, the remote control distance can be limitless.

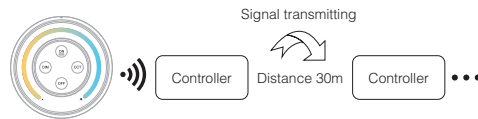

## PWM high frequency / low frequency switching

**Switch to high frequency (8KHz):** on the condition of turning on the light

1. Short press the "OFF" button of the remote control once;
2. Short press the "ON" button 5 times within 3 seconds, the white light blink 2 times quickly, indicating successfully.

**Switch to low frequency (500Hz):** on the condition of turning off the light

1. Short press the "ON" button of the remote control once;
2. Short press the "OFF" button 5 times within 3 seconds, the white light blink 2 times slowly, indicating successfully.

## Attention

1. Please check whether the voltage of the power supply is in accordance with the controller, and please check the connection of both the cathode and anode, otherwise the controller will be broken.
2. Please don't connect wires with power on. Please turn on again only when it is in right connection and no short circuit.
3. Please do not use the controller in the place with widely range metal area or strong electromagnetic wave nearby, otherwise, the remote distance will be seriously affected .



Made in China