

## Introduction

Controller adopt the widely used 2.4G wireless technology with the features of low power consumption, long signal transmitting and strong anti-interference, etc. Controller has auto-transmitting and auto-synchronizing function. Widely used on the controlling of hotel lighting and home lighting.

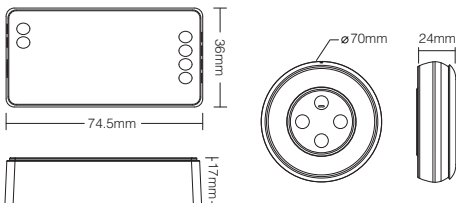

## Button Diagram

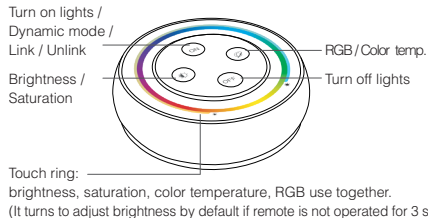

## RGB+CCT LED Controller Kits

Model No.: FUT039SA

## Parameters

### LED Controller

Working Voltage: DC12V~24V  
Output: 6A/Channel  
Total Output: Max 12A  
RF: 2.4GHz  
Control Distance: 30m  
Working Temperature: -10~40°C  
Output Connection: Common anode



16 Millions of  
colors to choose



Color temperature  
adjustable

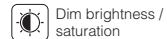

Dim brightness /  
saturation



2.4G RF wireless  
transmission technology

### Rainbow Remote

Working Voltage: 3V(AAA\*2PCS)  
Transmitting Power: 6dBm  
Standby Power: 20uA  
RF: 2.4GHz  
Modulation Method: GFSK



Remote control  
Control distance 30m



Smartphone App control  
(2.4GHz gateway is needed)



Support third party voice control  
(2.4GHz gateway is needed)



DMX512 controllable  
(DMX512 LED transmitter is needed)

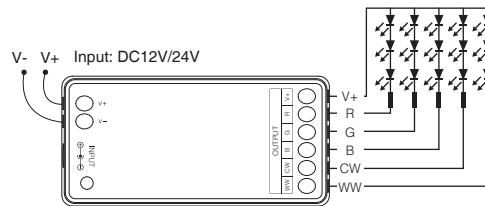

## Install The Battery For Remote

**Note: 2\*AAA Battery need to buy seperately**

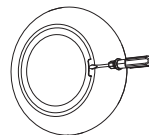

1. Open battery cover  
behind remote.

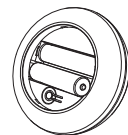

2. Install battery correctly and  
close battery cover.

## Remote Instruction

- Adjust RGB  
Short press key twice in succession, and then touch to adjust RGB.
- Adjust color temperature  
Short press key once, then touch to adjust color temp.
- Adjust saturation  
Press key twice in succession, and then touch to adjust color saturation of lighting.
- Adjust brightness  
Short press key once, then touch to adjust brightness.
- Dynamic mode switching  
Long press key until indicator light flashes twice, then short press key to cycle switch.  
(Note: it will exit automatically if no operation after 3 seconds)

## Linking Code / Unlinking Code Instructions

**Attention:** No need to match code since its already matched code in factory setting

### Linking Code Instructions

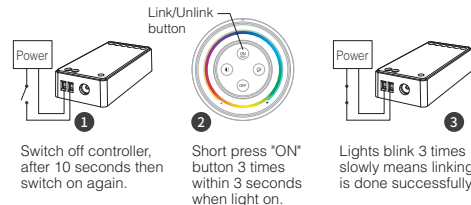

**!** Linking failed if light is not blinking slowly. Please follow above steps again.(Note: controller that have linked can't link again)

### Unlinking Code Instructions

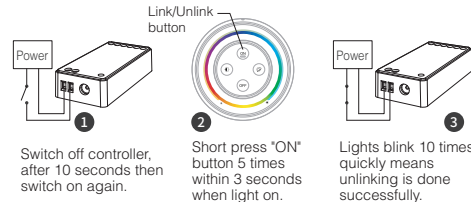

**!** Unlinking failed if light is not blinking quickly. Please follow above steps again.(Note: controller haven't linked that don't need to unlink)

## Signal transmitting

One controller can transmit the signals from the remote control to another controller within 30m, as long as there is a controller within 30m, the remote control distance can be limitless.

## Modes synchronization

Different controllers can work synchronously when they are started at different times, controlled by the same remote, under same dynamic mode and within 30m distance.

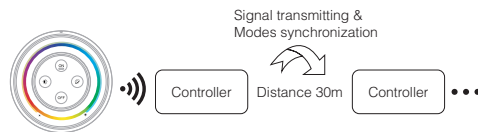

## PWM high frequency / low frequency switching

**Switch to high frequency (8KHz):** on the condition of turning on the light

1. Short press the "OFF" button of the remote control once;
2. Short press the "ON" button 5 times within 3 seconds, the white light blink 2 times quickly, indicating successfully.

**Switch to low frequency (500Hz):** on the condition of turning off the light

1. Short press the "ON" button of the remote control once;
2. Short press the "OFF" button 5 times within 3 seconds, the white light blink 2 times slowly, indicating successfully.

## Dynamic mode table

Number	Dynamic Mode	Brightness / Saturation
1	Mardi Gras	Adjustable
2	Automatic color change	
3	Sam	
4	Gemstone	
5	Twilight	
6	American	
7	Fat Tuesday	
8	Party	
9	Slow Color Splash	

## Attention

1. Please check whether the voltage of the power supply is in accordance with the controller, and please check the connection of both the cathode and anode, otherwise the controller will be broken.
2. Please don't connect wires with power on. Please turn on again only when it is in right connection and no short circuit.
3. Please do not use the controller in the place with widely range metal area or strong electromagnetic wave nearby, otherwise, the remote distance will be seriously affected .



## Compatible with DMX512 LED Transmitter (Purchase separately)

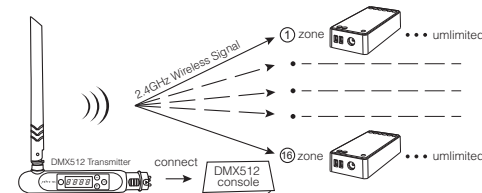

## Linking Code / Unlinking Code

- 1 Choose the zone for the controller by pressing ' + ' or ' - ' (e.g. 'CH12' means zone 12)

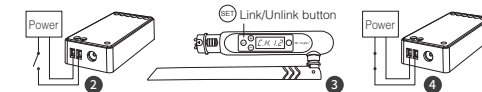

### Link Code

Switch off controller, after 10 seconds then switch on again.

Short press "Link/Unlink" button 3 times within 3 seconds when light on.

Lights blink 3 times slowly means linking is done successfully.

### Unlinking Code

Switch off controller, after 10 seconds then switch on again.

Short press "Link/Unlink" button 3 times within 5 seconds when light on.

Lights blink 10 times quickly means unlinking is done successfully.

**!** If the link or unlink failed, please follow the above steps again. (Note: controller that have linked can't link again, controller haven't linked that don't need to unlink).